

enteron 80 vertical

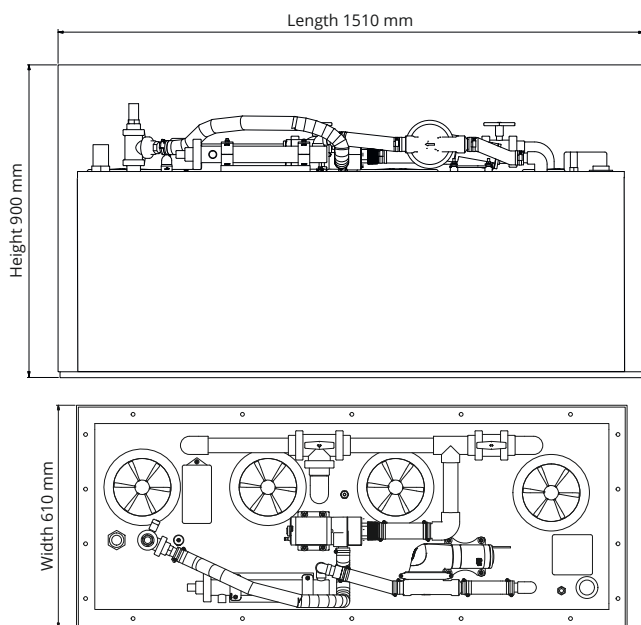

TECHNICAL DATA

Tank capacity. 165 l in operation
 Weight of the plant. . . . 50 kg
 Total weight ready
 for operation at least 600 kg
 Length 1500 mm (clear length 1510 mm)
 Width 600 mm (clear width 610 mm)
 Height. 875 mm (clear height incl. hoses 900 mm)
 Housing PEHD (tank)
 PVC-U (valves and pipes)
 Approvals. IMO/MARPOL/MEPC 227(64),
 Approval number 340.623
 Cleaning performance. . 80-120 l black water each day in normal operation
 Achieved BOD5 value. . . 10 mg/l (limit value 25 mg/l) in the outlet
 Bacteria in the outlet . . . 81 cfu/100 ml (limit value 100 cfu/100 ml)

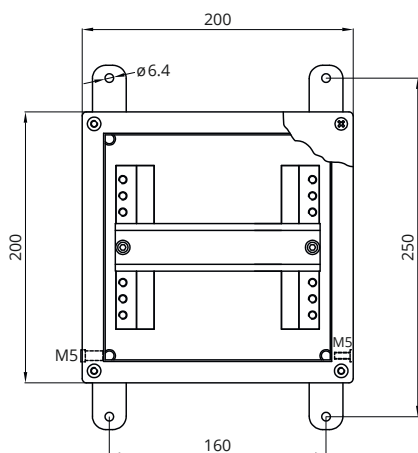

CONTROL ELECTRONICS

- fully encapsulated V4A installation housing with 2 m connected control cable and 10 m cable for remote control
- PLC control with possibility of remote maintenance and software update by installation companies
- display of operating and warning messages on a three-coloured text display
- length: 200 mm (260 mm incl. wall brackets)
- width: 200 mm
- height: 120 mm
- housing: seawater resistant stainless steel 1.4404

CONTROL SOFTWARE

- fully automated PLC control of all plant components
- operating system that cannot be manipulated by the user

REMOTE CONTROL

- length 95 mm
- width. 95 mm
- installation depth 50 mm
- required cut-out 65 x 65 mm
- housing. anodised aluminium